

# D822-LED

## Prismatic Outdoor Luminaire



### Job Information

Type:	
Catalog #:	
Project:	
Comments:	
Prepared by:	

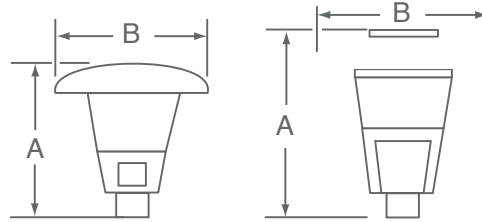

Sizes	A	B
Medium	24"	22"
Large	25-5/8"	26-3/8"

### Description

The D822-LED luminaire features classic architectural styling that blends beautifully in a wide range of commercial environments and landscape designs. Prismatic refractor lens with upper reflector for smooth symmetrical light distribution. Heavy gauge aluminum construction with durable, weather resistant polyester powder coat finish in a variety of standard and custom colors. Ideal for parks, urban plazas, shopping centers, boardwalks, apartment complexes, hotels and resorts.

### Ordering Information

Example: (D822-LED-60-40-UNV-T5-A-PT-DB-PC)



Series	Wattage/Lumen	Color Temp.	Voltage	Optics	Lens	Mounting	Finish	Option
Victory Luminaire	20	20W/2184 <sup>3,7</sup>	30	3000K	UNV	120-277V	T3 Type 3 T5 Type 5 <sup>1</sup>	A Acrylic P Polycarbonate
	30	30W/3276 <sup>3,7</sup>	35	3500K		347 347V		
	40	40W/4368 <sup>3,7</sup>	40	4000K		480 480V		
	60	60W/6552 <sup>3,7</sup>	50	5000K <sup>4</sup>				
	80	80W/8736 <sup>3,7</sup>						
						(Step-Down Transformer used for 347-480V)		
						PT Post Top 2 3/8" Tenon PT3 Post Top 3" Tenon OT Other Tenon MT <sup>5</sup> (Refer to pg 3. Please note that this is a separate order)	BZ Bronze <sup>1</sup> BL Black WH White SL Silver CU Custom <sup>2</sup>	PC Photocell <sup>5</sup> WSF Wired Single Fuse <sup>5</sup> WDF Wired Double Fuse <sup>5</sup> LS Light Shield

<sup>1</sup> Standard for fixture  
<sup>2</sup> Contact factory for custom finish  
<sup>3</sup> Delivered Lumens (5000K)  
<sup>4</sup> Standard Color Temp.  
<sup>5</sup> Specify Voltage (eg. 120V)  
<sup>6</sup> Refer to Page 3. Please note that this is a separate order.  
<sup>7</sup> Size 23 (20W-60W); Size 27 (80W)

Deco Lighting practices a program of continuous product development, and as a result product specifications change frequently. We reserve the right to change product specifications without notice. Contact Deco for the latest product information.

©2018 Deco Lighting, www.getdeco.com T: (800) 613-DECO F: (310) 366-6855  
 Rev Date: 01/25/18 #2

### Features

- Heavy-gauge die-cast and spun aluminum construction.
- Available with acrylic or polycarbonate prismatic reflector lens.
- Standard distribution pattern is Type V (360° circular).
- 180° internal cutoff shield is available as an option.
- Available in wattages up to 80W
- Three stainless steel allen screws secure the fixture.

### Photometric Data

D822-LED 80W Type III

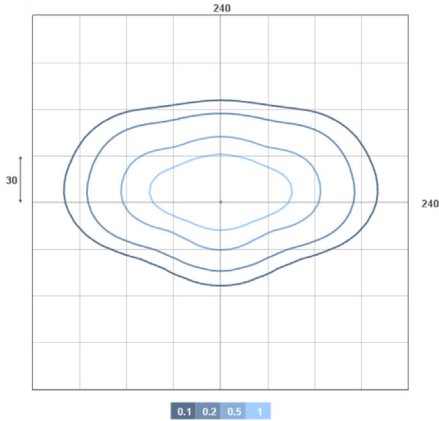

Calculation Area:	240'x240'
Point Spacing:	24'x24'
Max Luminance:	2.9 fc
Area > 0.5fc:	6732 ft²

D822-LED 80W Type V

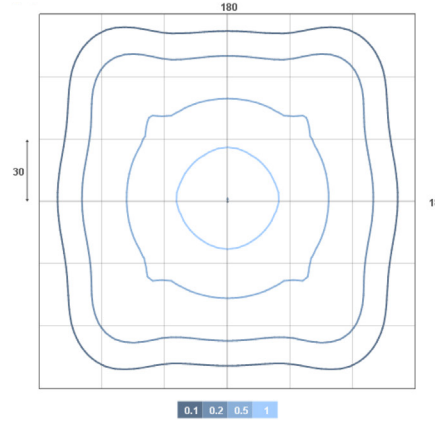

Calculation Area:	180'x180'
Point Spacing:	18'x18'
Max Luminance:	1.9 fc
Area > 0.5fc:	7533 ft²

### Performance Data

CRI:	80+			
CCT:	3000K, 3500K, 4000K, 5000K			
Warranty:	10 yr. Limited Warranty			
Dimming:	Available with 0-10V inputs dimming down to 10%			
Operating Temperature:	-40° to +55°C Max Ambient			
L70 Rating:	100,000+ Hours			
EPA:	1.3			
IP Rating:	IP65			
Power Factor:	> 0.90			
Total Harmonic Distortion:	< 20%			
Sound Rating:	Class A (inaudible in a 24dB ambient environment)			
BUG Rating:	Type 3	B3	U2	G3
	Type 5	B4	U1	G2

### Delivered Light Output & Equivalency Chart

HID to LED Replacement		
DELIVERED LUMENS	HID	LED Replacement
1300lm	50W	10W
2600lm	70W	20W
3900lm	100W	30W
5200lm	150W	40W
7800lm	175W	60W
11700lm	250W	80W
15600lm	400W	120W
26000lm	750W	200W
31200lm	1000W	240W

Interested in upgrading from HID to LED lighting? Use the conversion table above to get a general idea of what wattage LED fixture will replace your current lighting system. Lumen output and overall performance will vary by fixture, so please contact our factory or your nearest sales rep regarding specific questions on what wattage will best suit your desired space and application.

### Other Tenon Sizes

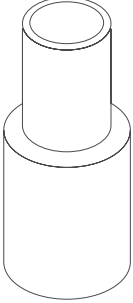

DRETA-3.5-TN3 (PT3.5)	Round External Tenon Adapter to Slip Over 3.5" Diameter Round Pole to 3" Post Top
DRETA-4-TN3 (PT4)	Round External Tenon Adapter to Slip Over 4" Diameter Round Pole to 3" Post Top
DRETA-5-TN3 (PT5)	Round External Tenon Adapter to Slip Over 4" Diameter Round Pole to 3" Post Top
DRETA-6-TN3 (PT6)	Round External Tenon Adapter to Slip Over 4" Diameter Round Pole to 3" Post Top

**Please note that this is ordered separately**