

IMPORTANT SAFETY INSTRUCTIONS

- To reduce the risk of death, personal injury or property damage from fire, electric shock, falling parts, cuts/abrasions, and other hazards please read all warnings and instructions included with and on the fixture box and all fixture labels.
- Before installing, servicing, or performing routine maintenance upon this equipment, follow these general precautions.
- Installation and service of luminaires should be performed by a qualified licensed electrician.
- Maintenance of the luminaires should be performed by person(s) familiar with the luminaires' construction and operation and any hazards involved. Regular fixture maintenance programs are recommended.
- It will occasionally be necessary to clean the outside of the refractor/lens. Frequency of cleaning will depend on ambient dirt level and minimum light output which is acceptable to user. Refractor/lens should be washed in a solution of warm water and any mild, non-abrasive household detergent, rinsed with clean water and wiped dry. Should optical assembly become dirty on the inside, wipe refractor/lens and clean in above manner, replacing damaged gaskets as necessary.
- DO NOT INSTALL DAMAGED PRODUCT! This luminaire has been properly packed so that no parts should have been damaged during transit. Inspect to confirm. Any part damaged or broken during or after assembly should be replaced.
- Recycle: For information on how to recycle LED electronic products, please visit www.epa.gov.
- These instructions do not purport to cover all details or variations in equipment nor to provide every possible contingency to meet in connection with installation, operation, or maintenance. Should further information be desired or should particular problems arise which are not covered sufficiently for the purchaser's or owner's purposes, this matter should be referred to Deco Lighting.



WARNING RISK OF ELECTRICAL SHOCK

- Disconnect or turn off power before installation or servicing.
- Verify that supply voltage is correct by comparing it with the luminaire label information.
- Make all electrical and grounded connections in accordance with the National Electrical Code (NEC) and any applicable local code requirements.
- All wiring connections should be capped with UL approved recognized wire connectors.



WARNING RISK OF RISK OF BURN

- Allow lamp/fixture to cool before handling. Do not touch enclosure or light source.
- Do not exceed maximum wattage marked on luminaire label.
- Follow all manufacturer's warnings, recommendations and restrictions for: driver type, burning position, mounting locations/methods, replacement and recycling.



CAUTION RISK OF INJURY

- Wear gloves and safety glasses at all times when removing luminaire from carton, installing, servicing or performing maintenance.
- Avoid direct eye exposure to the light source while it is on.



CAUTION RISK OF FIRE

- Keep combustible and other materials that can burn, away from lamp/lens.
- Do not operate in close proximity to persons, combustible materials or substances affected by heat or drying.



CAUTION RISK OF INJURY

- Never connect components under load.
- Do not mount or support these fixtures in a manner that can cut the outer jacket or damage wire insulation.
- Unless individual product specifications deem otherwise: Never connect an LED product directly to a dimmer packs, occupancy sensors, timing devices, or other related control devices. LED fixtures must be powered directly off a switched circuit.
- Unless individual product specifications deem otherwise: Do not restrict fixture ventilation. Allow for some volume of airspace around fixture. Avoid covering LED fixtures with insulation, foam, or other material that will prevent convection or conduction cooling.
- Unless individual product specifications deem otherwise: Do not exceed fixtures maximum ambient temperature.
- Only use fixture in its intended location.
- LED products are Polarity Sensitive. Ensure proper Polarity before installation.
- Electrostatic Discharge (ESD): ESD can damage LED fixtures. Personal grounding equipment must be worn during all installation or servicing of the unit.
- Do not touch individual electrical components as this can cause ESD, shorten lamp life, or alter performance.
- Some components inside the fixture may not be serviceable. In the unlikely event your unit may require service, stop using the unit immediately and contact an Deco Lighting representative for assistance.
- Always read the fixtures complete installation instructions prior to installation for any additional fixture specific warnings.

Electrical Connection

1. Connect BLACK (line) driver lead to voltage supply Line position (HOT).
2. Connect driver WHITE lead to the NEUTRAL supply position.
3. Connect the GREEN ground lead to the supply ground lead.

If using 0-10V dimming:

4. Connect VIOLET lead to supply POSITIVE dimming lead.
5. Connect GREY lead to the supply NEGATIVE dimming lead.

If NOT using 0-10V dimming:

6. Ensure VIOLET and GREY 0-10V dimming leads are properly capped.

Wiring Diagram

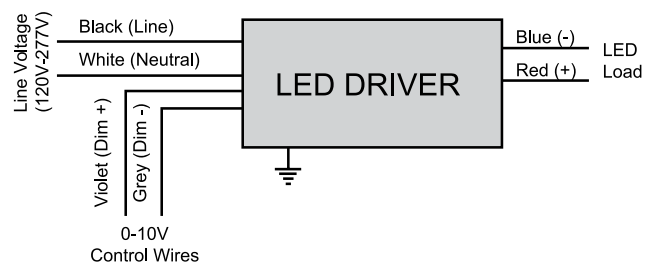

DCH-RET-LED

Deco Channel
Retrofit Kit

Installation Guide

DECO

retrofit™

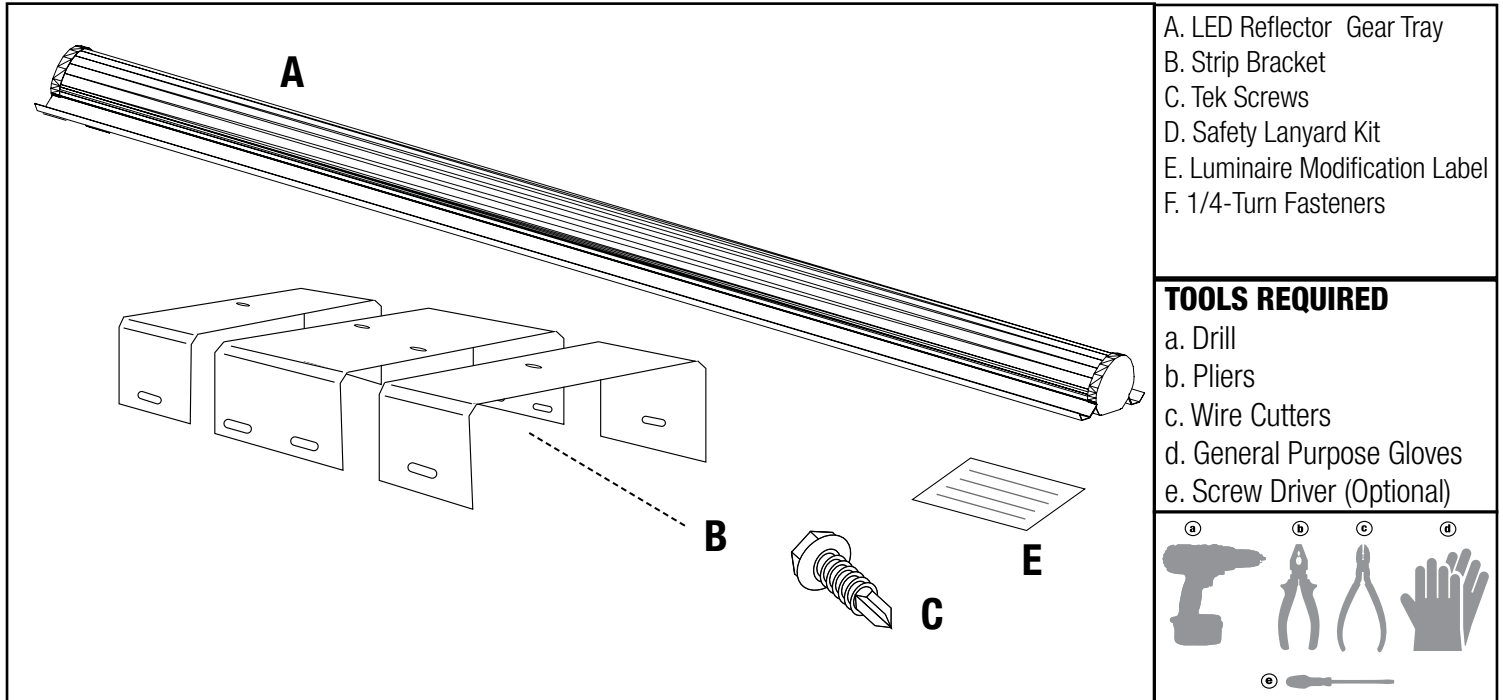

CAUTION: TURN OFF POWER BEFORE INSTALLING

DO NOT TOUCH LED

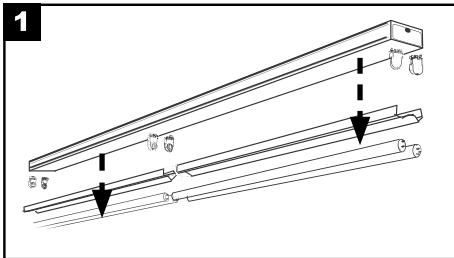

1 Remove lamps, ballast cover/reflector, socket bracket, and lamp holders from existing host strip luminaire.

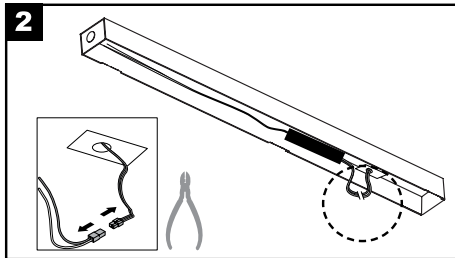

2 Disconnect AC mains from existing ballast. Depending on size and position of existing ballast, ballast may be removed or left intact.

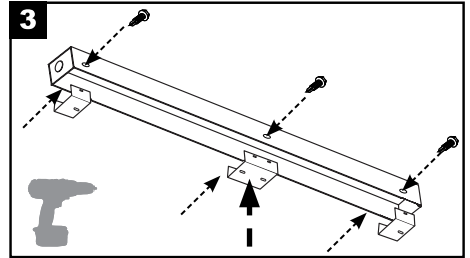

3 Use Self-tapping Tek Screws (C) to fasten Strip Bracket (B) to existing host strip fixture. For 8ft, make sure to align center piece of Strip Bracket with the center line of the host fixture.

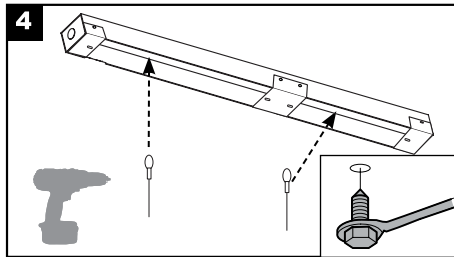

4 Secure Safety Lanyard cables (D) by fastening self-tapping tek screws (C) to existing strip housing. Make sure to feed tek screws through safety lanyard washers before fastening. Clip opposing end of safety cable to Gear Tray (A).

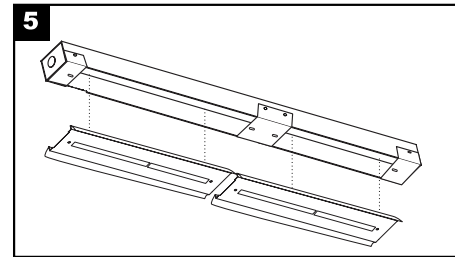

5 Clip opposing end of safety cable to Gear Tray (A). Use (2) Safety Lanyards for each 4-ft. gear tray section. Hang gear tray with safety cable in order to make electrical wire connection.

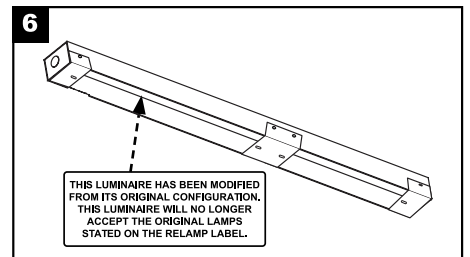

6 Place Label (E) inside existing host strip housing.

Deco Lighting practices a program of continuous product improvement, and as a result product specifications change frequently. We reserve the right to change product specifications without notice. Contact Deco for the latest product information.

7 Ground Connection

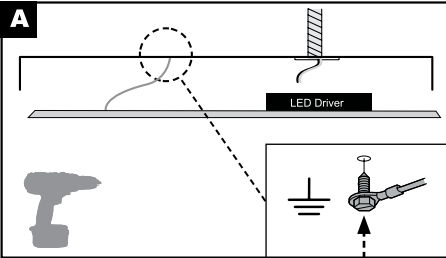

OPTION A:

Securely fasten ground screw lead from Gear Tray (B) to host strip fixture if host strip is grounded.

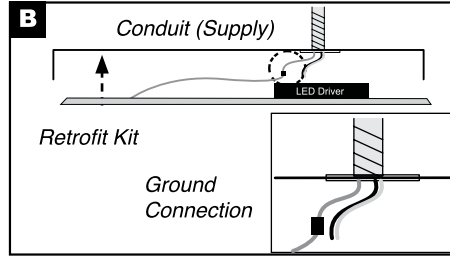

OPTION B:

Connect ground from Gear Tray (B) to supply ground lead from conduit.

8 Electrical Connection

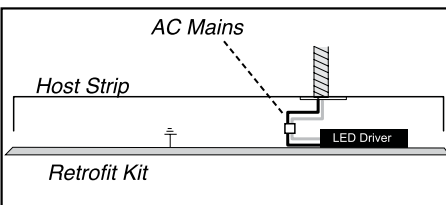

Follow instructions and wiring diagram on Page 2 to connect AC mains to Gear Tray input leads. Retrofit kit comes equipped with quick disconnect. Hide wires behind Gear Tray. Ensure leads do not hang out of Gear Tray to avoid electrical wiring being clamped between metal parts.

LED Wiring for 8ft

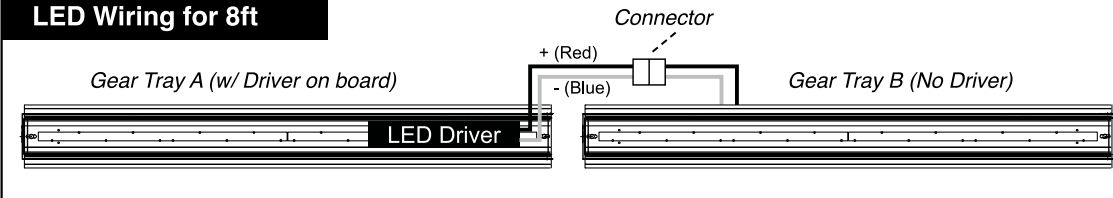

For 8ft. kit, the kit will come with (2) LED Gear Trays (A and B). Gear tray A will have a driver. Connect output leads from Driver located on Gear Tray A to the leads on Gear Tray B by plugging in connector. Ensure leads are connected correctly: Red (+) and Blue (-) from Driver to LED modules.

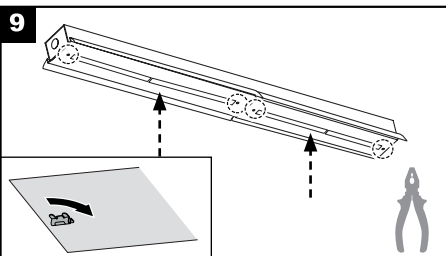

Push Gear Tray towards Strip Brackets so that the Gear Tray sits flush with the brackets and strip housing. Make sure the slots of the gear tray and brackets are aligned. Fasten Gear Tray by inserting and turning 1/4-turn fasteners (F) 90°.

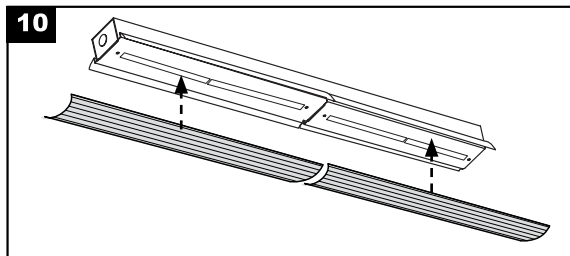

Remove protective packaging from LED modules and lens. Place Lens Diffuser onto retrofit kit by squeezing sides of Lens Diffuser and inserting edges into grooves of Gear Tray. Lens may need to be adjusted by squeezing sides or pressing the face of the lens.

