



Client: \_\_\_\_\_ Order #: \_\_\_\_\_  
Project Name: \_\_\_\_\_ Type: \_\_\_\_\_ Qty: \_\_\_\_\_

# EVIA-LED

## Suspended Direct/Indirect Luminaire

### Performance Data

CRI

83+

CCT

3000K, 3500K, 4000K

### Projected Lifetime

100,000+ Hours (L70)

### Dimming

Available with 0-10V inputs  
dimming down to 10%

### Operating Temperature

-30°C to +50°C Ambient

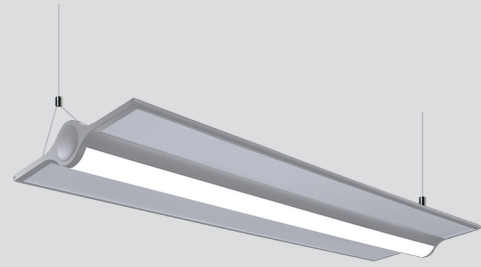

<b>UL</b> Listed	<b>10 Yr</b> Warranty Including Labor	<b>USA</b> Buy American Act Compliant
---------------------	---	---

### Description

The Evian series of interior suspended direct/indirect LED luminaires features a sleek, flat profile with dual-lensed light panels, aluminum construction, and slotted apertures. The modern Evian series delivers a nominal 50/50 distribution of uplight to downlight and is best suited for open offices, private offices, conference rooms, reception areas, educational facilities and public spaces.

### Features

- Construction: Impact resistant, surface mounted aluminum housing, with dual lensed LED light panels in an aluminum extrusion. Also, featuring ABS plastic end caps.
- Reflectors: 99% pure aluminum inside reflector, up to 60% of uplight and 40% of down light are emitted.
- Diffuser: Semitransparent linear prismatic PMMA diffuser.
- Mounting: A square power entry canopy, featuring a suspension system with coated steel wires and a safe height adjustment system—optimal for all types of ceiling options.
- Electrical: 0-10V dimming optional.



### Ordering Information

<b>A</b> FIXTURE SERIES	EVIA-LED	Evian LED Series
<b>B</b> WATTAGE/LUMENS	50	50W/6244 <sup>1</sup>
<b>C</b> CCT	30	3000K
	35	3500K
	40	4000K
<b>D</b> VOLTAGE	UNV	122-277V

<b>E</b> MOUNTING	Cx	Mounting Cable (x= see page 2 for length)
<b>F</b> OPTION	DM	0-10V Dimming

<sup>1</sup> Delivered Lumens (4000K)

**Dimensions**

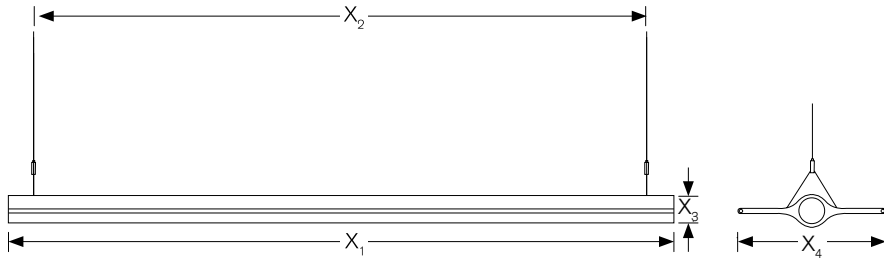

	Inches
<b>X<sub>1</sub></b>	47.24
<b>X<sub>2</sub></b>	43.8125
<b>X<sub>3</sub></b>	3.14
<b>X<sub>4</sub></b>	14.17

**Photometrics**

Coefficients of Utilization - Zonal Cavity Method  
Effective Floor Cavity Reflectance: 20%

RCC %:	80				70				50				30				10				0
RW %:	70	50	30	0	70	50	30	0	50	30	20	0	50	30	20	0	50	30	20	0	0
RCR: 0	1.07	1.07	1.07	1.07	.99	.99	.99	.50	.83	.83	.83	.69	.69	.69	.69	.56	.56	.56	.56	.50	.50
1	.97	.92	.88	.84	.89	.85	.81	.40	.72	.69	.66	.59	.57	.55	.55	.48	.47	.45	.45	.40	.40
2	.88	.80	.73	.68	.81	.74	.68	.34	.62	.58	.54	.52	.48	.46	.46	.42	.40	.38	.38	.33	.33
3	.80	.70	.62	.56	.73	.65	.58	.28	.55	.49	.45	.45	.42	.38	.38	.37	.34	.32	.32	.28	.28
4	.73	.62	.54	.47	.67	.57	.50	.24	.48	.43	.38	.40	.36	.33	.33	.33	.30	.27	.27	.23	.23
5	.67	.55	.47	.40	.61	.51	.43	.21	.43	.37	.33	.36	.32	.28	.28	.29	.26	.24	.24	.20	.20
6	.62	.49	.41	.35	.57	.46	.38	.19	.39	.33	.29	.33	.28	.25	.25	.27	.23	.21	.21	.18	.18
7	.57	.44	.36	.31	.52	.41	.34	.17	.35	.29	.25	.30	.25	.22	.22	.24	.21	.18	.18	.16	.16
8	.53	.40	.32	.27	.49	.37	.30	.15	.32	.26	.22	.27	.23	.19	.19	.22	.19	.16	.16	.14	.14
9	.49	.37	.29	.24	.45	.34	.27	.13	.29	.24	.20	.25	.21	.17	.17	.21	.17	.15	.15	.13	.13
10	.46	.34	.26	.22	.42	.31	.25	.12	.27	.22	.18	.23	.19	.16	.16	.19	.16	.13	.13	.11	.11

**Zonal Lumen Summary**

Zone	Lumens	%Luminaire
0-30	812.8	13%
0-40	1,318.9	21.1%
0-60	2,291.2	36.7%
60-90	831.1	13.3%
70-100	750.8	12%
90-120	1,335.3	21.4%
0-90	3,122.3	50%
90-180	3,118.5	50%
0-180	6,240.8	100%

Model 50W 4000K

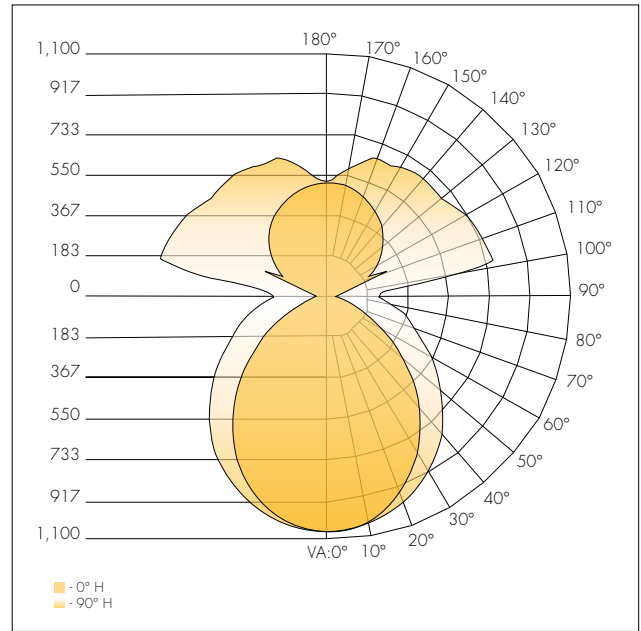

**Mounting Cable Lengths**

CA	24" Cable
CB	48" Cable
CD	60" Cable
CF	72" Cable
CG	96" Cable
CH	120" Cable
CJ	150" Cable
CK	180" Cable
CL	240" Cable